

BLUEPRINTS FOR THE HANDYMAN
 A Div. of General Leisure Corporation
 PO Box 1888
 340-3545 32nd Ave NE
 CALGARY, ALBERTA, CANADA
 T1Y 6M0

NOTICE
 The purchaser agrees when purchasing this plan (the "Plan") that the purchaser has acquired the right to build or construct the project or project set out in the Plan for personal use only and not for any commercial use.
 2) reproduction of the Plan in whole or in part by any means whatsoever is strictly prohibited. The Handyman should not be liable for any willful misuse or negligent use of this plan, the Project or any tools used to construct the Project or for any loss or damage resulting therefrom.

NOTE: Read all directions before beginning
 Carpenters Glue should be used to reinforce all joints
 Set all nails and countersink all screws

Directions

- 1) Lay out your material on the workbench, as outlined in the suggested material layout (Fig 1). Draw out all parts exactly as illustrated in cutting diagram (Fig 2), including the letter designations, in pencil. Ensure to leave a small space between cut lines to allow for the width of your saw or router. All dimensions are in inches unless otherwise specified. They are shown in feet and inches on the inside of the lines. Saw all edges. You can cut the rabbit joint in pieces B and C (Fig 3) with a table saw with the blade set at a 1/2" depth. Test this depth on a scrap piece of wood. Remember to cut on the waste side of the line, and to chisel out the waste to allow for a tight fit. You can use a jigsaw or keyhole saw to cut the curve in P. Using a depth gauge, (Illustration 2) drill the pieces B and C as shown to a depth of 3/8", using a 1/4" drill bit (Assuming your shelf brackets are 1/4").
- 2) Stand pieces B and C on their front edges, about 3/4" apart. Run a bead of glue along the rabbit joints and position in piece A. Nail A to pieces B and C with 1 1/2" finishing nails. Stand the unit up and place a bead of glue along the top edges of A, B, and C. Position on piece D flush with rear third side edges, nailing to A, B, and C with piece E flush with rear third side edges, nailing to A, B, and C with glue along the bottom, inside of A, B, and C. Position in place H flush with the bottom edge and nail it in with 1 1/2" finishing nails.

OTHER



SHELF SUPPORT BRACKETS

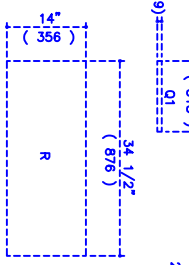
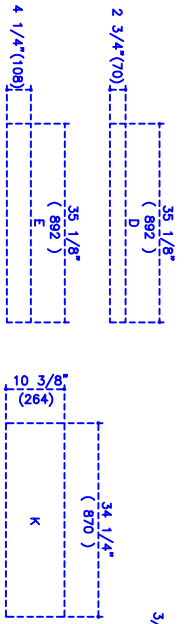

DRILL DEPTH GAUGE ILLUSTRATION 1

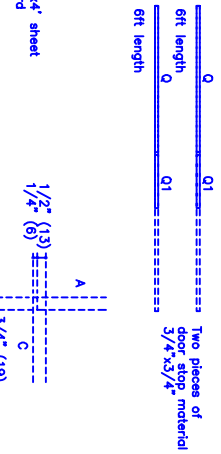
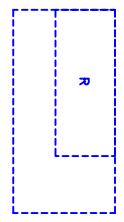
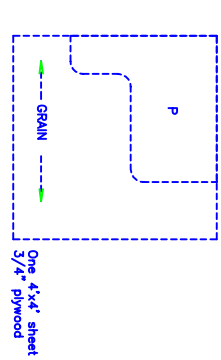
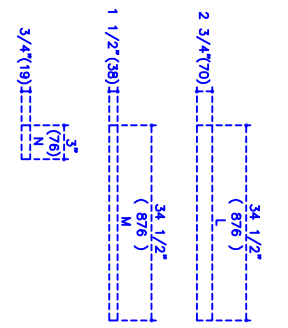
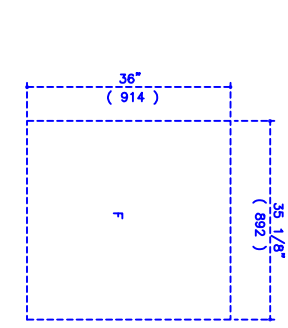
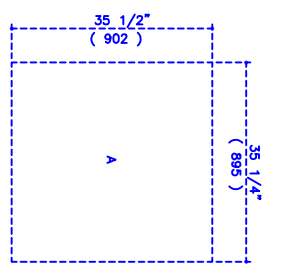
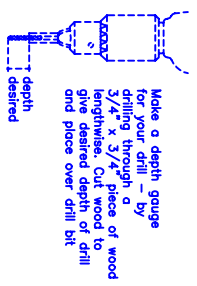

MATERIAL LAYOUT FIGURE 1

FIGURE 3

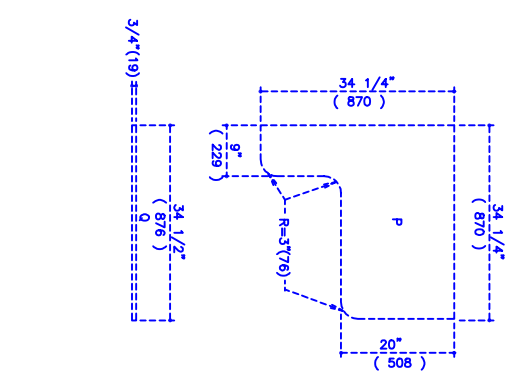
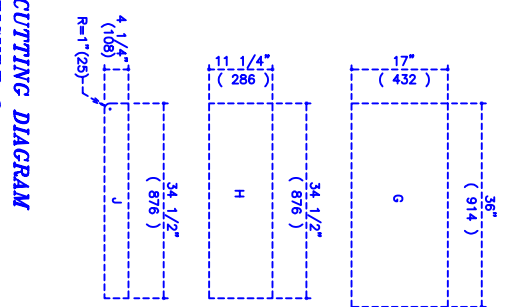
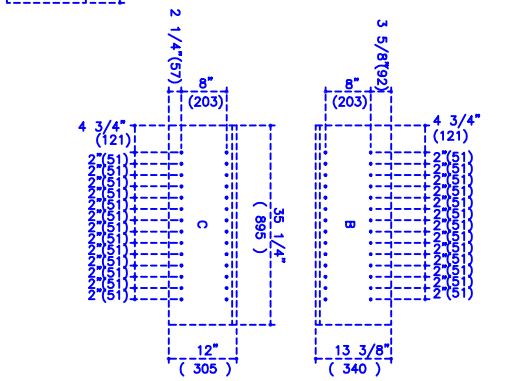

CUTTING DIAGRAM FIGURE 2

MATERIALS LIST

- Two 4'x8' sheets 3/4" plywood G2S (NCL)
- One 4'x4' sheet 3/4" plywood G1S (KCB)
- Two 3'x3'x3/8" sheets solid wood (3mm)
- One 1'x3'x3/4" pine hinge & hardware
- Two 32" x 1 1/2" dia. shelf support brackets
- Sixteen 1/4" dia. shelf support brackets

MATERIALS LIST

- One magnetic door catch & hardware
- One 2" surface latch & hardware
- Approx. ten 3" #8 finished screws for mounting to wall
- Approx. 1/2 lb. 1 1/2" finishing nails
- Approx. 1/2 lb. 1 1/2" finishing nails

MATERIALS LIST

- One 6' length 1-1/2" pine hinge
- One door stop material 3/4" x 3/4"
- Wood filler
- Sandpaper
- Enamel paint
- Carpenter's Glue

Blueprints for the Handyman Presents
HOME HOBBY CENTER - Project #805

© 1987, 1990 Blueprints for the Handyman